



# Campaign Prayer

**O Miraculous Infant Jesus! We beseech You to cast a merciful look on our troubled hearts. Let your tender heart, so inclined to pity, be softened at our prayers and grant us that grace which we ardently implore (for the success of our *Generation to Generations* campaign). Take from us the affliction and despair, the trials, and misfortunes with which we are laden. For the sake of Your sacred infancy, hear our prayer and send us consolation and aid that we may praise You with the Father and the Holy Ghost forever and ever.**



## *Dear Faithful of St. Lawrence and Friends of Our Parish,*

From the moment the *Mater Dei Community* was entrusted to the care of the Priestly Fraternity of St. Peter, it has been our responsibility to lead the community in the worship of God using the traditional patrimony of the Church, especially through the Holy Sacrifice of the Mass. We are also responsible for guiding your souls towards heaven through the administration of the sacraments, but also through preaching, and the many pastoral activities that help make our parish such a vibrant home.

From the time that Bishop erected us as a proper parish, you had a permanent spiritual home of your own in this diocese giving you a chance to live out your Catholic Faith in a normal parochial setting as your ancestors have done for countless centuries, enriched by the traditional forms of the sacraments.

When we were later given the opportunity in 2022 to purchase St. Lawrence Church from the cathedral parish with the help of a \$1.5 million loan from the diocese, the most important piece of our parish life was firmly established: not only did we have a normal parish structure (where children could receive First Holy Communion and Confirmation and where traditional weddings and requiems could be held) but also a church – and a most glorious church at that – in which the ancient, sacred rites could be celebrated in peace.

Many from the parish will recall that special time in January and February of 2022 when the future of the FSSP was not certain. Our superiors ask us to join them in a novena from Feb. 2 to 10, unable to announce publicly that two of our priests would meet with Pope Francis on Feb. 4.

At the end of January, we were also not sure about the purchase of the church, and we asked you to join us in a novena for that intention. Also, all at the same time, purchasing 112 State Street became a possibility, but we certainly did not have the resources, so we turned to the FSSP to ask them to buy it for us until we could raise the money to purchase it from them. The FSSP had never done something exactly like that before. We asked you to join us in a novena for that intention as well.

During those weeks we ended up praying all three novenas, sometimes overlapping with each other, and the Lord wondrously granted all three intentions: with Pope Francis issuing a special decree for the FSSP on Feb. 11, the feast of Our Lady Immaculate of Lourdes; Bp. Gainer and his College of Consultors agreeing to the sale and 100-percent financing of St. Lawrence Church; and the FSSP's North American Province agreeing to purchase of 112 State Street and giving us five years of free use of the property with the option to buy it at the end.



It was an amazing time to see the work of the Lord in our parish's life, and we rejoice now in the blessings received then that we still experience every day here at our parish.

We are so grateful for the security granted to the FSSP and to be a parish with a full sacramental life according to the traditional forms of the sacraments and ability to worship God in such a noble way. We are grateful to have a church with so much beauty, which induces us to pray. We are also grateful for the beautifully renovated parish center at 112 State Street, which allows so much of our parish life to thrive, providing class rooms, a library, a bookstore, offices, reception rooms, storage and more.

We are confident that God, who began a good work in us will see it to completion. With this harvest of blessings comes the practical responsibility of caring for the buildings that God has entrusted to us, which support our parish life and allow our mission to thrive.

The *Generation to Generations* Capital Campaign is a response to that responsibility. It is not undertaken simply for expansion, nor for short-term gain, but to address real and longstanding needs. Thanks to the generosity of the FSSP, we've had free use of the parish center at 112 State Street for three and a half years, which means that the five-year deadline is fast approaching. Parishioners have told us that securing it for the parish is their top financial priority.

Similarly, due to the purchase of the church building, we have a substantial mortgage, and parishioners would like to see the parish be debt-free. Along with important repairs to the church and social hall, and expansion of rectory space, these are necessary projects that will allow St. Lawrence to remain stable and suitable for ministry in the years ahead, and lay the ground work for future growth.

This campaign asks us to think beyond our own time. Those who came before us made sacrifices so that this parish could exist as it does today. We are now asked to do the same for those who will worship here in the future. Through thoughtful stewardship and generous sacrifice, we can help ensure that St. Lawrence continues to serve as a worthy place for the worship of God and the formation of Catholic life.

✦ ✦ ✦ **As you read through this case statement,  
I ask you to prayerfully consider how you  
may take part according to your means.**

In corde Iesu,

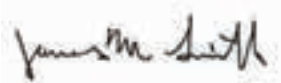

REV. JAMES SMITH, FSSP  
Pastor



“

*“In 2005, Bishop Rhodes welcomed the FSSP to pray the Traditional Latin Mass at St. Lawrence. Through the past 20 years despite the struggles, the congregation's prayers and commitment have brought forth many blessings resulting in a thriving parish. We have been there from the start and have a vested interest to see St. Lawrence parish continue to flourish as a place where all can be in communion with our Lord's heavenly embrace.”*

**WILLIAM AND  
PATRICIA GABIG,  
Honorary Chairs**

# Our Parish



St. Lawrence Church provides a stunningly beautiful home for the worship of Almighty God. Each day of the week, the worthy Sacrifice is offered up to Him on the altars of this Church, which has been entrusted to the priests of the Priestly Fraternity of St. Peter (FSSP), a community of priests established by Pope St. John Paul II in 1988. The mission of the priests is first, their own sanctification, and second, the sanctification of those who come to worship with them using the Traditional Latin Mass. By seeking God above all things, priests and Faithful alike, by God's grace, render themselves more pleasing to Him, and more loving of their neighbors.

## FROM GENERATION TO GENERATIONS

Through the *Generation to Generations* campaign, we have an opportunity to lay a stronger foundation for the young people of our parish and for future generations to grow in faith here at St. Lawrence. With your support, *Generation to Generations* will establish firmly our position as a mature parish without debt, maintain and improve the spaces needed for the many activities its vibrant life requires, and preserve the beauty and tradition of our church and liturgy.

Our vibrant parish is thriving, and by the grace of God, we hope to accomplish several critical projects that with God's help will ensure St. Lawrence is well-positioned for many years to come. Our campaign goals include:

### *Purchase the Parish Center from the FSSP | \$900,000*

At the request of the parish, the Priestly Fraternity of St. Peter (FSSP) generously purchased the adjacent Parish Center building at 112 State Street when the parish did not have the funds to do so. The FSSP has given us five years of free usage of the space, with a deadline of June 2027, to raise the funds necessary to purchase this building from the FSSP or to vacate it. The Parish Center is a three-story (plus finished basement), multi-use facility that is vital to the operations and ministry of the parish. It is imperative that we preserve access.

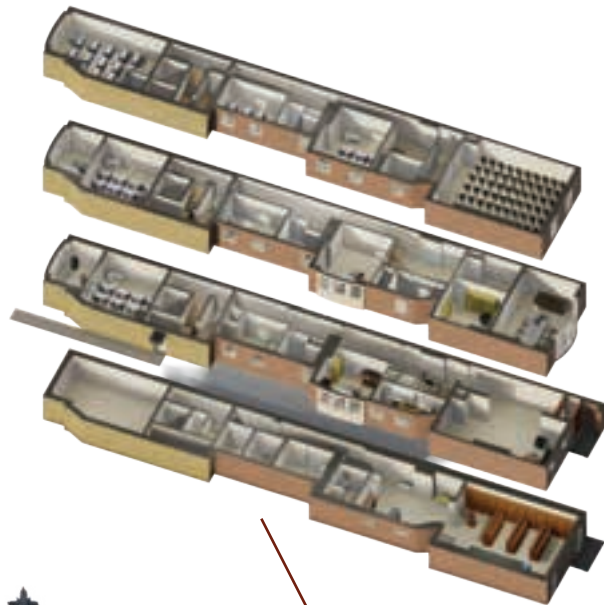

*"When our family joined St. Lawrence in 2022, we felt like the man who discovered a pearl of great price. The sacrifices we've made along the way have been more than worth it, as this parish and its people continue to help us grow in holiness through the gift of the Mass of the ages."*

**ROBERT AND  
PAMELA KOLE,**  
*General Chairs*





***Eliminate the Parish Debt | \$600,000***

The parish's debt stems from the \$1.5 million mortgage taken on by the parish in 2022 to purchase the church from the cathedral. Our principal payments according to the terms of the mortgage are \$75,000 per year, but we have aggressively been making extra payments on the mortgage so that the amount we owe is now down to \$900,000. By June 2029, the amount remaining would be \$600,000. By eliminating this debt, we will invest those monthly savings into further pastoral work and our campus.

***Expand the Rectory Space | \$300,000***

The current rectory space is at capacity for our priests, and has no dedicated guest room. This lack of space creates various challenges. For instance, when more than one guest visits – such as two seminarians – the chapel is inaccessible for prayer. We also hope that eventually, as the parish grows, we would have the possibility to have a fourth priest, which is currently impossible.

With \$300,000, we would have the funding needed to acquire an adjacent house – making the two combined houses into one living space – or sell the current building and purchase a larger building closer to the church.

***Restore the church's rose window and improve the social hall | \$300,000***

Our church's beloved rose window is in disrepair, needing professional restoration. The restoration process includes repairing the stone, repointing the grout, removing the layer of plexiglass, and tending to the stained glass itself. This would greatly enhance the beauty of the church's façade, letting in more light through the rose window.

Additionally, we must maintain and improve our social hall, which is actually part of a structure connected to the church known as the schoolhouse. The social hall needs several updates to make the place bigger, more beautiful, and welcoming. Plans call for:

- Adding central heating and air conditioning to the whole building
- Expanding the social hall back to its original size by removing the wall between the old library and the social hall
- Removing the drop ceiling in the social hall to create more vertical space
- Improving the lighting
- Replacing windows and flooring, if funding allows

Further, our improvements to the church would include renovating part of the sacristy to create more storage space, including for the sacred vestments that are used at Mass. Currently, we have exhausted our vestment storage space and some vestments are stored in ill-fitted temporary containers. Storing the vestments properly is very important as they are quite precious, and improper storage can cause them to crease, wear, and tear due to getting caught on sharp edges.



# Campaign Goals

The *Generation to Generations* campaign has three tiered fundraising goals. Each tier represents a milestone that allows the parish to move forward responsibly, with projects completed in order as commitments are received.

**ST. LAWRENCE GOAL**  
**\$1.5 million**

Purchase the Parish Center, eliminate \$300,000 of parish debt, restore the church's rose window, and complete improvements to the social hall.

**ST. THOMAS GOAL**  
**\$1.8 million**

Completely retire the parish's debt by paying off the final \$300,000.

**MATER DEI GOAL**  
**\$2.1 million**

Acquire additional rectory space for our priests, visiting seminarians, and to have the possibility in the future for a fourth priest.



# Ways to Give

There are many options to help meet your needs while supporting St. Lawrence in a meaningful way. Selecting the best gift plan depends on your personal financial situation and goals. You may want to consider stretching pledges over a three-year period to maximize the total amount of support. This commitment can be fulfilled through monthly, quarterly, semiannual or annual installments.

Pledges are commitments made in good faith. Because tax laws change and each situation is unique, donors are encouraged to consult with their financial advisor to determine which method of contributing is most beneficial.

**We encourage all donors to consider a 10% to 20% initial payment to begin their commitment to ensure we can purchase the Parish Center by June 30, 2027 and begin work on the rose window restoration and social hall improvements.**

## *Cash or Check*

Gifts made by cash or check are the most common and will allow St. Lawrence to address its immediate needs. Checks should be made payable to St. Lawrence Church.

## *Online Giving*

Visit [www.stlawrence.cc/campaign](http://www.stlawrence.cc/campaign) to set up payments by credit/debit card or bank withdrawal.

## *Gifts of Securities*

Gifts of stocks, bonds or mutual funds are encouraged when supporters want to make a charitable gift and avoid capital gains tax. Please reach out to the parish office during business hours for delivery details to share with your brokerage provider to complete your gift to the *Generation to Generations* Capital Campaign.

## *Direct Qualified Charitable Distribution from a Retirement Account*

Benefactors can make charitable gifts using funds from tax-deferred individual retirement accounts (IRAs). Donors may use this strategy to satisfy part, or all, of their required minimum distribution and lower overall tax liability to benefit St. Lawrence.



*“We view St. Lawrence as our second home, a refuge and fortress for every true joy in this life, providing all that is needed to face the daily trials before us. A place for our families to be with Christ, contemplate Him, learn from him, love and worship Him with our priests and fellow parishioners. We will continue to place our trust in Him, cooperating with His grace to provide the best for our families, giving all that we can to maintain and grow our parish for generations to generations knowing that His generosity surpasses all of our efforts and attempting to fulfill Christ’s command to Love the Lord thy God with thy whole heart, mind, soul, and strength, and to love thy neighbor as thyself.”*

**LANCE AND  
DAWN FORBECK,  
General Chairs**

## *Planned Gifts*

Planned gifts provide opportunities to make a meaningful commitment to the campaign now as part of your financial and estate planning. Such gifts can allow donors to accomplish charitable giving goals and take advantage of tax laws.

Opportunities may include:

- Bequests from a will or a living trust
- Life insurance
- Real estate
- Designating St. Lawrence as a beneficiary (for example, brokerage transfer on death agreement, retirement account beneficiaries or life insurance beneficiaries)
- Various trust options (for example, a charitable lead trust)

*This information is not intended as legal advice. You are advised to consult your own qualified professional advisor for specific recommendations.*



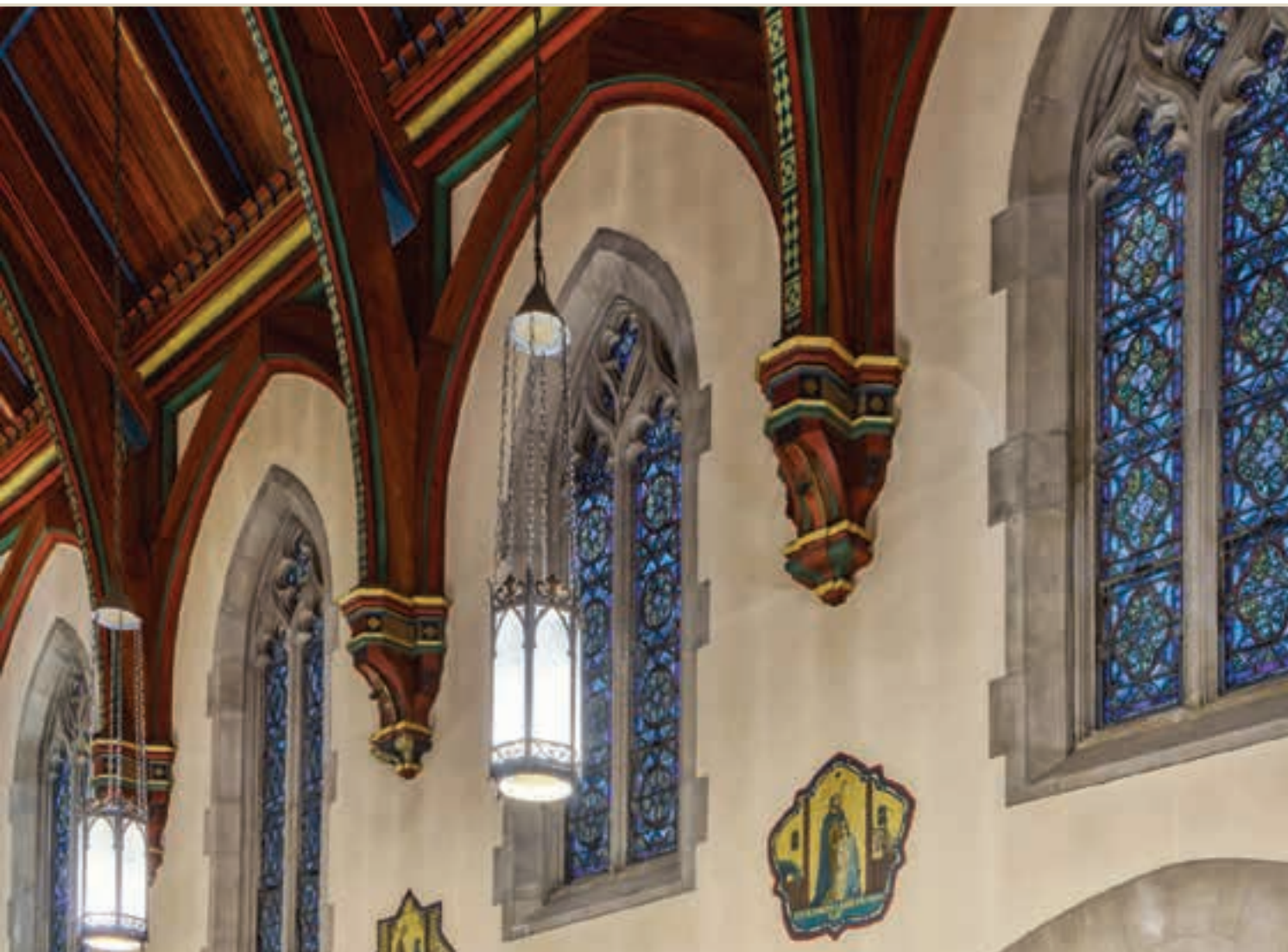

This chart serves as a guide as you prayerfully consider your level of support.

Total Gift	Initial 10% Investment	Balance	Monthly	Quarterly	Semiannual	Annual
\$75,000	\$7,500	\$67,500	\$1,875	\$5,625.00	\$11,250	\$22,500
\$50,000	\$5,000	\$45,000	\$1,250	\$3,750.00	\$7,500	\$15,000
\$30,000	\$3,000	\$27,000	\$750	\$2,250.00	\$4,500	\$9,000
\$15,000	\$1,500	\$13,500	\$375	\$1,125.00	\$2,250	\$4,500
\$10,000	\$1,000	\$9,000	\$250	\$750.00	\$1,500	\$3,000
\$6,000	\$600	\$5,400	\$150	\$450.00	\$900	\$1,800
\$3,600	\$360	\$3,240	\$90	\$270.00	\$540	\$1,080
\$1,800	\$180	\$1,620	\$45	\$135.00	\$270	\$540

*Note: The incremental payment examples are based on an initial 10% investment followed by the preferred payment plan for three years.*



## CAMPAIGN LEADERSHIP

### *Pastor*

Rev. James Smith, FSSP

### *Assistant Pastors*

Rev. Cidrian Cortes, FSSP

Rev. Ronald McCann, FSSP

### *General Chairs*

Lance and  
Dawn Forbeck

Robert and  
Pamela Kole

Bob and  
Karen Smisl

### *Honorary Chairs*

William and  
Patricia Gabig

Michael and  
Krista Mae Garcia

Duane and  
Lindsay Whitlock

### *Development Counsel*

Steier Group

